

RECOMMENDED PANEL CUTOUT FOR SINGLE WALL PLATE AND BACK PANEL FOR DOUBLE WALL PLATE

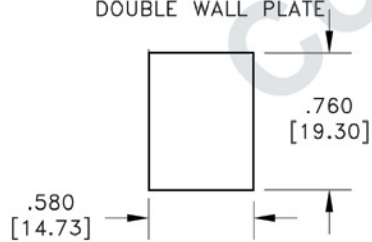

RECOMMENDED FRONT PANEL CUTOUT FOR DOUBLE WALL PLATE

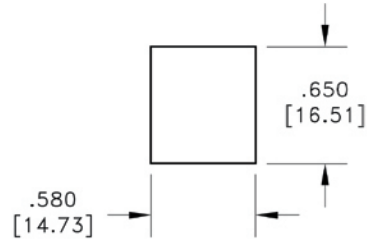

1 MATERIAL:

- HOUSING: PA-767 94V-0 ULE. 46920
- CONTACTS: PHOSPHOR BRONZE, 50u" GOLD PLATE OVER NICKEL.
- SHIELD: COPPER ALLOY

2. ALL DIMENSIONS ARE MAXIMUM UNLESS OTHERWISE SPECIFIED.

3. LABEL ON EACH COUPLER TO READ AS FOLLOWS: LABEL SIZE IS (.375" X .625").



4. COUPLER PACKAGED IN A 4" X 5" CLEAR POLYBAG WITH LABEL READING AS FOLLOWS:



5. DIMENSIONS IN BRACKETS ARE IN MILLIMETERS.

6. CAVITIES CONFORM TO FCC RULES & REGULATIONS PART 68, SUBPART F.

7. MAXIMUM PANEL THICKNESS IS .062 INCH.

DESCRIPTION: SHIELDED COUPLER ASSEMBLY, 8 POSITION, ENHANCED CAT 5

CHK:

APRVD:

REV.:

DWG BY: D. PHAM

COLOR:



DATE: 02/16/2001

MATERIAL:



DO NOT SCALE

DWG NO. C.D. 1509

PART NO.:

FM451