

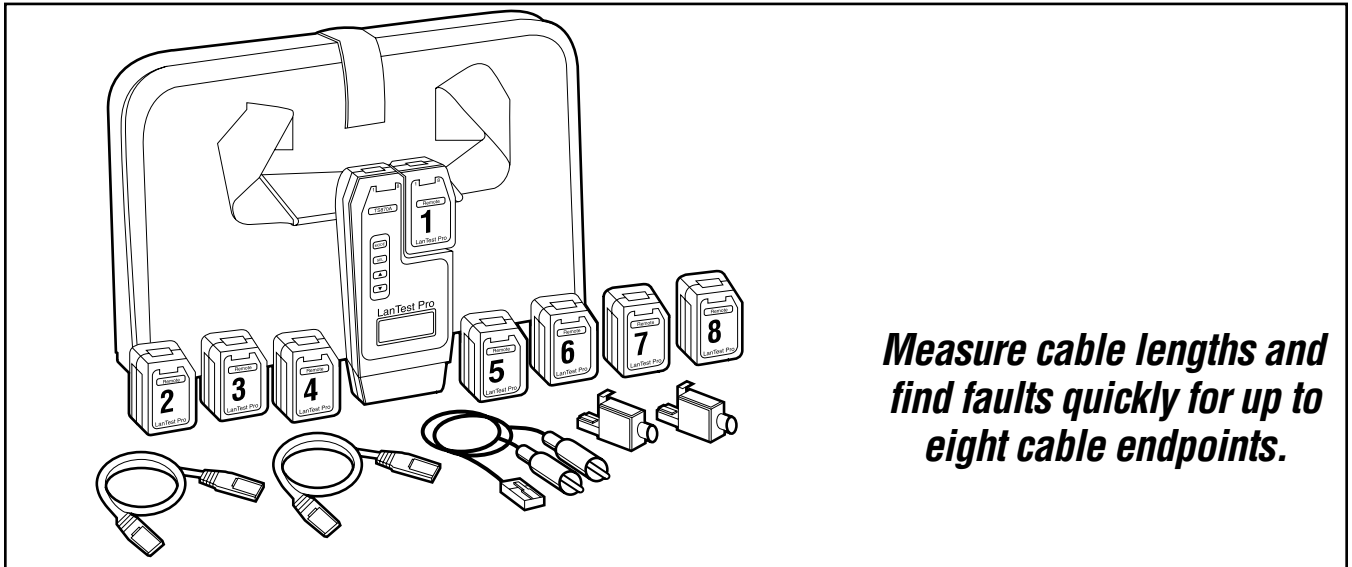

BLACK BOX[®]

NETWORK SERVICES

LANTEST AND LANTEST PRO CAT 5E TESTER/ANALYZERS



Measure cable lengths and find faults quickly for up to eight cable endpoints.

Key Features

- ▶ **Test for shorts, opens, miswires, reversals, and split pairs.**
- ▶ **Cable test results are displayed in wire map format with a message line for shorts and split pairs.**
- ▶ **Automatic start-up and shutdown: just plug both ends of the cable into the tester.**
- ▶ **Two-line by 16-character alphanumeric LCD with icons shows clear results.**

Test new or installed premise wiring for networks and data systems with the LANTest or LANTest Pro Kit. It checks shielded and unshielded UTP and STP CAT3, CAT4, CAT5, and CAT6, and also coax cables. (Adapters for coax are included with the LANTest Pro Kit.)

Use the tester three ways: without the remote, with the remote, or with the Network Probe (TS155-R2).

To check for shorts, opens, and split pairs, you won't need the remote. But to test for miswires and reversals, you'll need the remote.

You can also use the tester with the Network Probe (TS155-R2) to generate a tone for testing.

The LANTest Pro Cat 5e Tester/Analyzer Kit includes eight remotes for testing cable runs to more than one endpoint. The

length range is 6 to 320 feet (1.8 to 100 m) for both the LANTest and LANTest Pro.

The tester includes a 9-V alkaline battery and operates in four modes:

- Cable testing mode. With no remote attached, the LANTest checks for shorts, opens, and split pairs. When the remote is attached, the LANTest also checks for miswires and reversals.
- Length measurement mode. Measure the length of a cable in auto select, or choose each pair to measure length individually. Adjust the cable parameter by the capacitance per unit length value, or by a known length of cable.
- Setup mode. Select either shielded twisted-pair (STP) cable or unshielded twisted-pair (UTP) cable. Beeper on/off and units of measure are also selectable variables.

- Tone generator mode. Select individual wires and pairs to carry a tone. To trace tones, you'll also need to order the Network Probe (TS155-R2). Here's how it works: Suppose you have a jumble of cables in a wiring closet. One of these cables runs to a nearby office. To find the other end of the office cable in the closet, you can use the tester to generate a tone. Then, when you wave the Network Probe near the bundle of cables, the probe will beep when it locates the desired cable.

When you need to find cable length, test for shorts, opens, miswires, reversals, and split pairs, or trace cable, choose the LANTest CAT5e Tester/Analyzer. If you need additional remotes to test multiple cable runs, select the LANTest Pro CAT5e Tester/Analyzer Kit.

Why Buy From Black Box? Exceptional Value. Exceptional Tech Support. Period.

Recognize any of these situations?

- You wait more than 30 minutes to get through to a vendor's tech support.
- The so-called "tech" can't help you or gives you the wrong answer.

- You don't have a purchase order number and the tech refuses to help you.
- It's 9 p. m. and you need help, but your vendor's tech support line is closed.

According to a survey by Data Communications magazine, 90% of network managers surveyed say that getting the technical support they need is extremely

important when choosing a vendor. But even though network managers pay anywhere from 10 to 20% of their overall purchase price for a basic service and support contract, the technical support and service they receive falls far short of their expectations—and certainly isn't worth what they paid.

At Black Box, we guarantee the best value and the best support. You can even consult our Technical Support Experts before you buy if you need help selecting just the right component for your application.

Don't waste time and money—call Black Box today.

What's Included

LANTest CAT5e Tester/Analyzer (TS870A)

- (1) LANTest main unit
- (1) remote unit
- (2) 1-ft. (0.3-m) jumper cables
- (1) 9-V alkaline battery
- (1) carrying case
- (1) users' manual

LANTest Pro CAT5e Tester/Analyzer Kit (TS875A)

- (1) LANTest main unit
- (8) remote units
- (2) 1-ft. (0.3-m) jumper cables
- (1) RJ-45 to (2) alligator clips cable
- (2) RJ-45 to F coax adapters
- (1) 9-V alkaline battery
- (1) carrying case
- (1) users' manual

Specifications

Cable Test Lengths:

Maximum: 320 ft. (100 m);
Minimum: 6 ft. (1.8 m)

Cable Types: Shielded or unshielded CAT3, CAT4, CAT5, CAT5e; coax (with adapters attached)

Switch: To prevent the 20 second "no activity" power off, periodically press the "fault check/tone" switch.

Temperature: Operating: 32 to 122°F (0 to 50°C);
Storage: -4 to +158°F (-20 to +70°C)

Humidity: 10 to 90%, noncondensing

Power: (1) 9-V alkaline battery

Typical Alkaline Battery Life:

Cable Testing: 120 hours (times are for the full capacity of the battery used continuously in cable testing mode)

Size: 5.7"H x 2.9"W x 1.2"D (14.5 x 7.4 x 3 cm)

Weight (with battery installed): 0.4 lb. (0.2 kg)

Ordering Information

ITEM	CODE
<i>For testing cable to a single point, order...</i>	
LANTest CAT5e Tester/Analyzer (1 Remote).....	TS870A
<i>For multipoint testing, order...</i>	
LANTest Pro CAT5e Tester/Analyzer Kit (8 Remotes)	TS875A
<i>For tracing tones, order...</i>	
Network Probe.....	TS155-R2



Black Box offers the best warranty program in the industry—Fido Protection®. For more information, request **FaxBack 22512**.